

MILITARY BUNKER VERSION EYE OF OSIRIS PROJECT



Products and services insured by



TechnoKontrol is a member of the



National Fire Protection Association
The authority on fire, electrical, and building safety

INDEX

4	Global Emergency, National Security Food Production Plants Eye of Osiris Project - Military Bunker Version
8	Why the Eye of Osiris?
12	How it is done?
22	Solutions against all types of internal or/and external threats
36	Eye of Osiris Project technical information
58	Eye-Section Data-Command Centre
60	Cyber security
62	Eye of Osiris Complex - Technical maps
76	TK-Eye of Osiris Global Environment
78	TK-Eye of Osiris Technotelecom
80	TK-Eye of Osiris Global Engineering
82	TK-Eye of Osiris Global Electronics
84	TK-Eye of Osiris Emergency Command-Call Centre
86	TK-Eye of Osiris Military-Law Enforcement Living Quarters Designs
88	TK-Eye of Osiris Elite Black Night Viper Security Services
90	TK-Eye of Osiris Search & Rescue/Combat Search & Rescue



GLOBAL EMERGENCY
NATIONAL SECURITY FOOD
PRODUCTION PLANTS
EYE OF OSIRIS PROJECT
MILITARY BUNKER VERSION



EYE OF OSIRIS

The Eye of Osiris Project is a mixture of high food technological production, with twenty first century technology, know how, research and investigation all mixed into the creation of the largest Emergency-National Security Food Production Plant in the World.





WHY THE EYE OF OSIRIS?

How many times have we all wondered what would happen to our families, friends and society in general if for whatever reason there was a real food and water shortage? How could we feed ourselves? With what, how, where and for how long?

These questions are asked everyday by many of the top scientists, politicians, military and even the security agencies of our modern day societies. What would be the alternatives, Anarchy? Riots? Looting? Sabotage? Terrorism? War?

These random but probable and realistic disasters which can destroy our society in days or weeks have to be anticipated and we cannot allow ourselves the luxury for others to plan for our safety and well being as these "saviors" could also find themselves in the same disastrous situation as ourselves.

This is why our corporation, which is naturally commercially driven but also socially and morally, has also the need and the obligation to anticipate these issues from the moment that we know that they exist.

This is why the Eye of Osiris™ has been developed, patented, hence as to create a corporate mixture of commercial, security, safety and emergency principles and ecologically driven production all the time with an eye on providing the world with a future "Humanitarian-Social-Security-Safety-Emergency Insurance Policy".

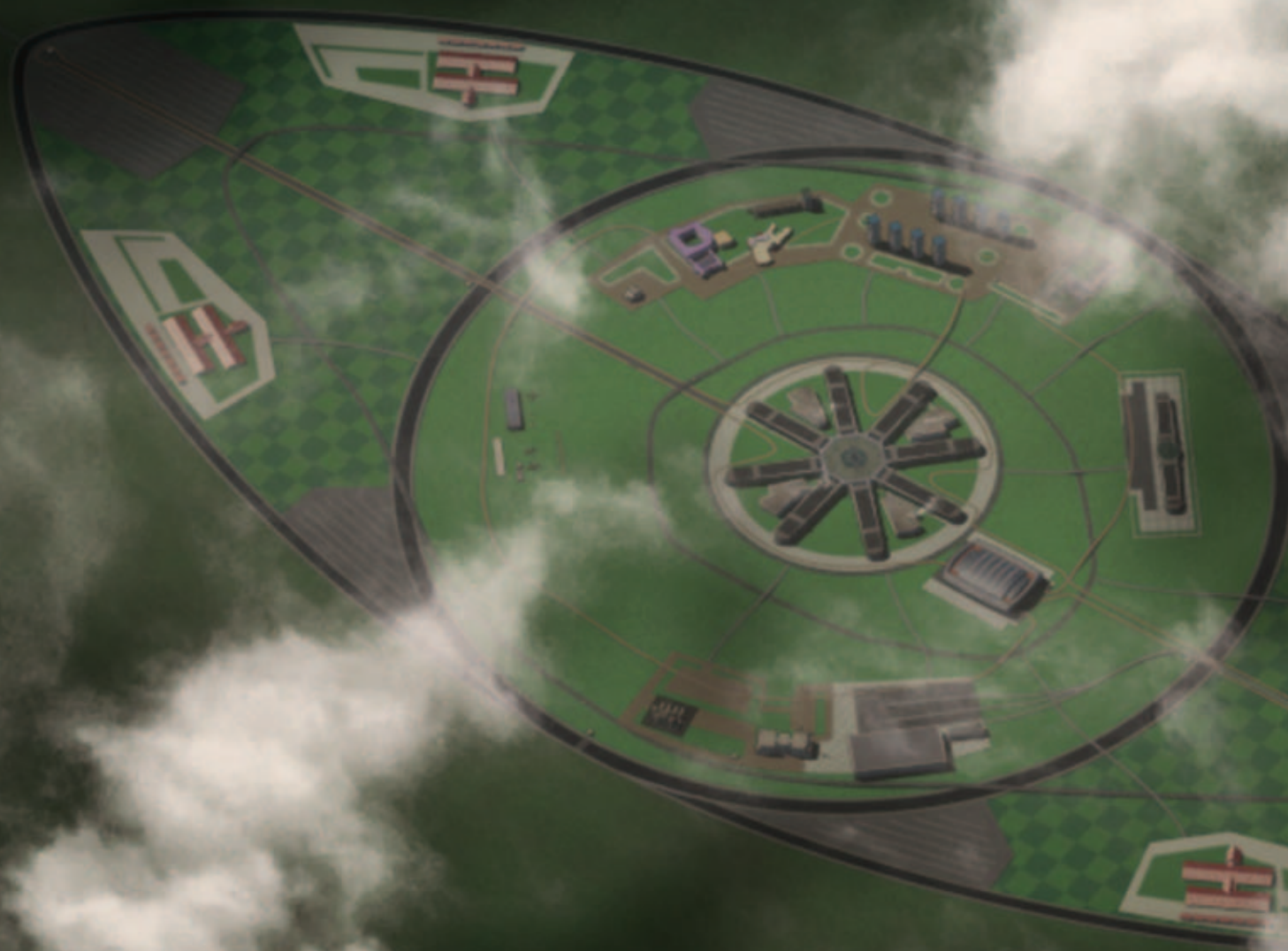



HOW IS IT DONE?

The land extension required will depend on the used or required “version” but as a minimum requirement the project would need a minimum of 100,000-500,000 meters to two (2+)-five (5+) million square meters with access to rail freight / air cargo facilities and the appropriate access in order to transport both goods and livestock.



HYDROPONIC GREEN HOUSE PRODUCTION SECTIONS

The internal sectors of the “Eye of Osiris” are designed to be able to produce any food, any plant, herb, animal, fish, insect, reptile as desired by the operator depending on a nations needs, customs and estimated emergency needs in the event of requiring “shut down” in an emergency scenario.

We have been able to design the project in such a way that each section can be acclimatized individually including humidity, heat, climate control, total exterior plant/food protection due to weather changes, incidents, natural disasters, thus protecting all crops, production and also being able to increase, decrease, pause, any and all production in each and every scenario.

The hydroponic green house sections and buildings have a roofing area of between 100,000-500,000metres to several million square meters of solar panels covering all sides of the building, wind turbines, diesel non-contaminating exhaust backup engines and bio-digesters whom will serve & function by using all food waste, animal waste and even recycling inorganic waste as tires, rubber, inorganic waste, without contamination.



FOOD PRODUCTION, TRANSFORMATION AND PACKAGING

The "Eye of Osiris plant" not only can produce fresh fruit, vegetables, spices, fish, reptiles, insects, pharmacy-medical plants-flowers, meats, dairy products but also has the capacity to transform such products into other products.

These can be used for wholesale or for internal national consumption as being able to feed state controlled authorities as hospitals, schools, military, universities, national emergencies, low income persons including canning, freezing, dehydrating, etc.

Thus allowing the foods to have a full cycle use, no waste, and most importantly extremely long shelf life for emergency food-survival-military requirements and also not forgetting natural disasters, civil unrest, terrorism acts, war, etc.



OTHER TYPES OF WASTE MANAGEMENT/INORGANIC RECYCLING/TK-METEOR 6000

Others types of waste even inorganic products as tires, rubbers, plastics are used via our "TK-Meteor 6000 Recycling Power Generating Plants" to recycle this contaminating products without any external CO-CO2 carbon emissions-contamination and being able to re-use, recycle these products into crude oil, carbon, steel and even refining from crude oil into diesel fuel.

The bio-digesters recycling plants produce methane gas to power the "Eye of Osiris" as much as possible and thus making the whole project a eco-friendly food producing and manufacturing plant.

All the exotic fruits, pharmacy-medical products which are normally imported from long distances into the respective countries would hold production priority in order to reduce both travel contamination and transport prices as these products normally have a higher production and transport cost.

Depending on each "Eye of Osiris" final installation-location some products, foods, will become "exotic" due to their location as depending where the "Eye of Osiris" is installed as in the arctic region, deserts, jungles, city centers, these food products grown will increase the savings due to not needing foreign imports and gaining full food national independence, security and national safety in this national strategic sector as food production.



Main features:	Technical data:
Autoclave completely made of stainless steel (316)	Container size (H x W x D)
Exclusive recycling system	Height 2.40 m
Any emissions (during loading) into the atmosphere	Width 2.27 m
Size of complete installation (20 m)	Length 6 m
Up to 2,750 items per year can be processed (700 hours working)	Workplace dimensions (see sheet 20 m)
Double compression between containers	Container height 1.90 m
Electronic control of all machine functions	Volume 30 m ³
Working area with 2 x chimney, 20 m ² with a pumpstation	Container 1.82 m
Temperature reduction outside of 100 bars: +40°C	Length 6.5 m
3 phase motor 2.2 kW 3 gear into the site system	Door size 800 kg
System is controlled by a PLC	Minimum stock 30,000 kg
30% water consumption	Maximum stock size of material 1.2 m
Water supply for loading and unloading the materials into the furnace	Power consumption 60 kW
Machine for the CO control	4 Refrigeration systems
Estimated production of 2000 items of waste oil with complete load of materials	Independent partition control system
Working approximately 1,200 kg of waste oil with full charge of the machine	2.5 ton maximum speed
Working approximately 2,400 kg of material with full charge of the machine	Complete operation cycle duration 24h
Production of approximately 200 m ³ of slag with full charge of the machine	Inside temperature 2320°C
Production of approximately 2,400 kg of material with full charge of the machine	Outside temperature +40°C
Production of approximately 200 m ³ of slag with full charge of the machine	Door opening system - manual open
Production of approximately 2,400 kg of material with full charge of the machine	Max load for heavy material: 10,000 kg
Production of approximately 200 m ³ of slag with full charge of the machine	Door
Production of approximately 2,400 kg of material with full charge of the machine	Height 2.20 m
Production of approximately 200 m ³ of slag with full charge of the machine	Width 2.27 m
Production of approximately 2,400 kg of material with full charge of the machine	Depth 2.75 m
Production of approximately 200 m ³ of slag with full charge of the machine	Height of the empty machine 2070 kg



PHARMACY-MEDICAL
HERBS, SPICES, ROOTS,
INSECTS, REPTILES

Are also paramount for the long term production, R&D into new medicines and also to mass produce anti-viral, bio-chemical medicines during an period but especially in an emergency period without imports and alternative medicine production or R&D.

Flowers normally imported from Egypt, Colombia or Kenya would also be produced on the same principles.

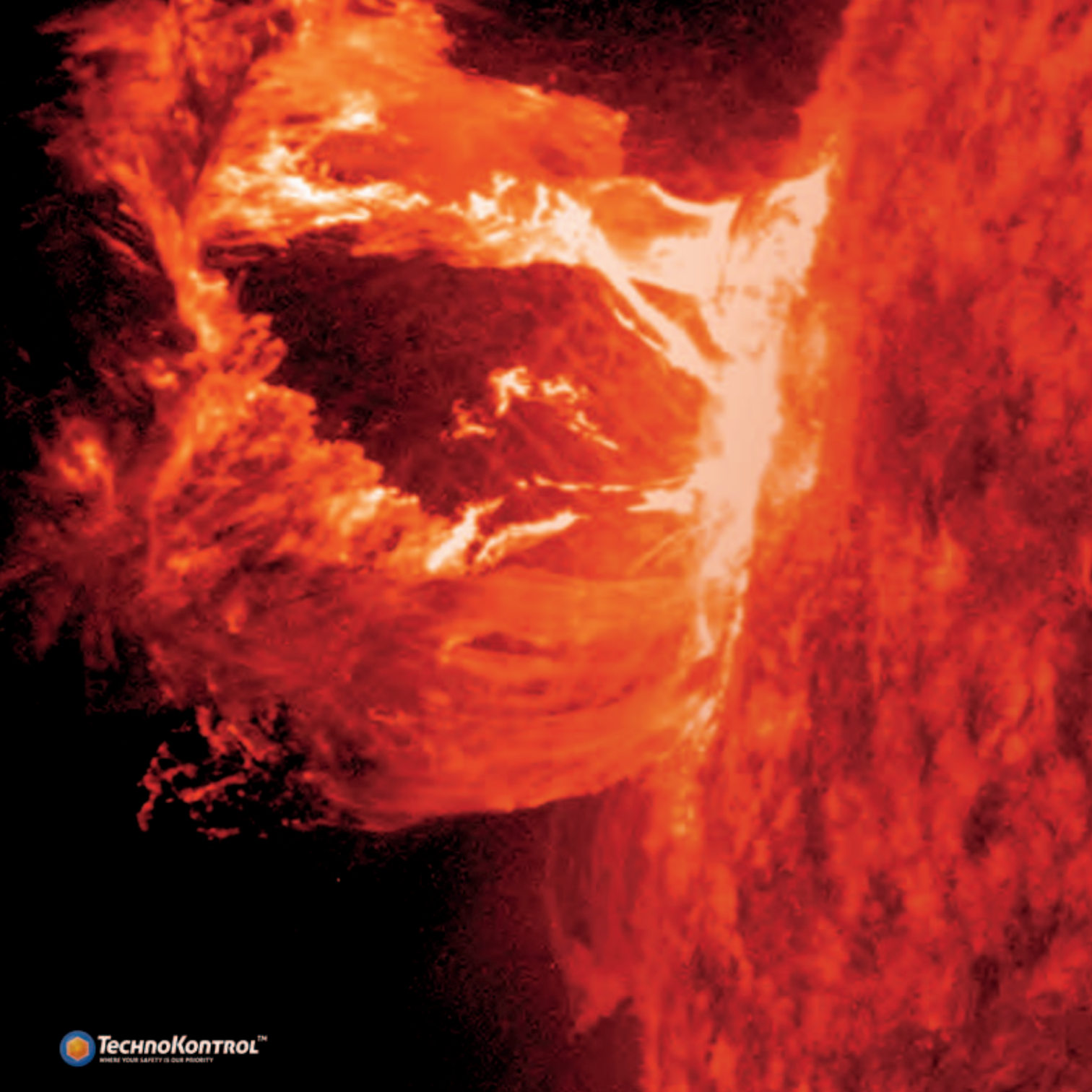

SOLUTIONS AGAINST ALL TYPES OF INTERNAL OR/AND EXTERNAL THREATS

We have the technical capacity and know how to protect our buildings at under-ground level with protection against natural disasters including "solar radiation/solar heat waves", to military or terrorist "EMPS Pulse" attacks. (Electromagnetic Pulse Attacks) using the basement sectors as underground security and safety bunkers for any use and even having an underground "Eye of Osiris" 100 % independent from the top sector to be able to continue to produce food, seeds, products in any case scenario and thus feeding the general population, government, military or State.



PHYSICAL, SABOTAGE, TERRORIST, MILITARY ATTACK ON THE EYE OF OSIRIS BUNKER

In the event of any level of attack to the "EYE OF OSIRIS" via land, sea or by air depending on the strategic nation importance of these plants they are prepared to be defended at all levels, from private security, law enforcement and to the highest military levels by means of anti-missile systems, ground troops, and especially once the "Bunker" has been "closed-shut down."

Thus being able to train, maintain, feed and have at disposal thousands of troops for an external contra-attack or to withstand attacks and thus protecting production for internal and external usage, distribution and logistics once the risk have be cancelled from other external forces.



LACK OF FUELS

*Energy, Food, Water, Waste Management, Distribution,
Logistics in the Event of an Emergency Scenario*



POWER/ENERGY

The Eye of Osiris™ Project, animal farming, manufacturing, waste economics, digester plants, biomass plants, natural gas plants, solar, wind and recycling inorganic power plants will all be introduced as to combine all the energy production into one auto-recyclable unit.





WATER/LIQUIDS HUMAN USAGE

The Eye of Osiris™ Project has its own water supply, water may be obtained for underground wells, air-water condensation, liquids from waste management technologies, juices, liquids from fruit & vegetable production.



WASTE MANAGEMENT

The same will apply to the use of animal waste phosphates to cultivate presently low quality soil and thus maximize the use of all the possible land available to us in order to become extremely recyclable and efficient all year round, internally or externally regardless of any present or future climate changes.



ANIMAL FEEDING

Using recycled foods from the "Flora Sections" of the Eye of Osiris, third rate products due to their commercial image(not quality) or left over leaves, skins, pulp, as from the "papaya trees", which we know can make a milk producing animal like cows, goats, to produce up to 20%-30% more milk and with an average of 25%-50% less animal sickness, infections, medicines also due to the great beneficial medical benefits of these anti-cancer fruits, their leaves and fruit skins which we would normal destroy but in the case becomes free feeding produce for our "animal sections" in the "Eye of Osiris".

The animal waste and slaughter waste from these "animals" again is re-used to produce methane gas via gas digesters and then used to power the plant or assist the general gas power supply of the "Eye of Osiris" to maintain constant humidity, climate controls in each and every section of the project.



EYE OF OSIRIS™ PROJECT

TECHNICAL INFORMATION

- Total length: 5,000 meters. (Depending on designs).
- Length to the Eye Section: 2,250 meters. (Depending on designs).
- Eye Section width: 500 meters. (Depending on designs).
- Eye section height: 36 meters. (Depending on designs).
- Average width: 450 meters. (Depending on designs).
- Total floors: 6. (Above ground 2, underground 4). (Depending on designs).
- Height per floor at ground level: 1+2 /12+ meters (Total 24-48 meters).
- Height per floor underground level: 8+ meters (Total 32-50 meters).
- The whole structure will be externally covered by solar panels.
- The interior will be lightened by artificial lighting especially designed for max. growth yields.
- Interior of building will also be covered by high intensity solar panels to create a recyclable energy producing system. (Mirror-Reflex technology)
- All roofing will be prepared to re-conduct all rain fall into sub-level water filtering deposits to be recycled and used in the project.
- The whole structure will be built on a higher level to prevent flooding and which all exterior of the project will have mass water-collecting systems at ground level.
- Electromagnetic fields are used to increase food growth depending on which products.
- Heating and cooling systems for the hydroponic greenhouses will be biogas gas turbines, which can be connected to solar, bio-diesel, digester, wind turbine, power energy, inorganic recycling plants.
- Law Enforcement Security Systems and technologies.
- Military “bunkerized” food production emergency plants.



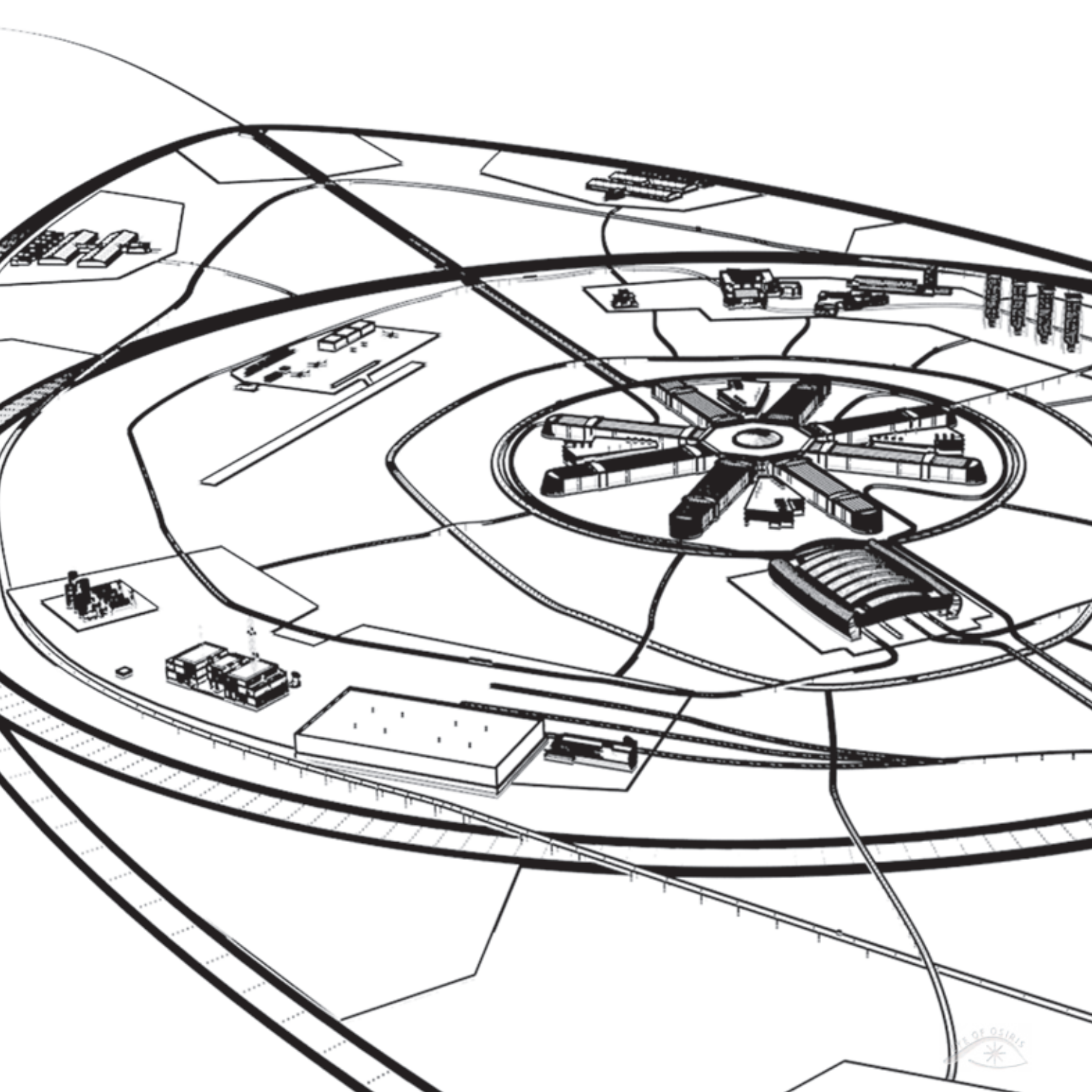



LEVEL DESCRIPTION

LEVELS 1, 2, 3(-1) & 4(-2)

ABOVE GROUND LEVELS

High yield hydro phonic plantations with full automatic Ted watering, feeding and pest free growing production. Levels -1 & -2 High yield hydro phonic plantations as the above. At these levels their will be an independent connecting procedure to which in the event of a natural disaster, Levels 1 & 2 were to be destroyed or non-operational, these two levels -1 & -2 could maintain full production capacity and development.

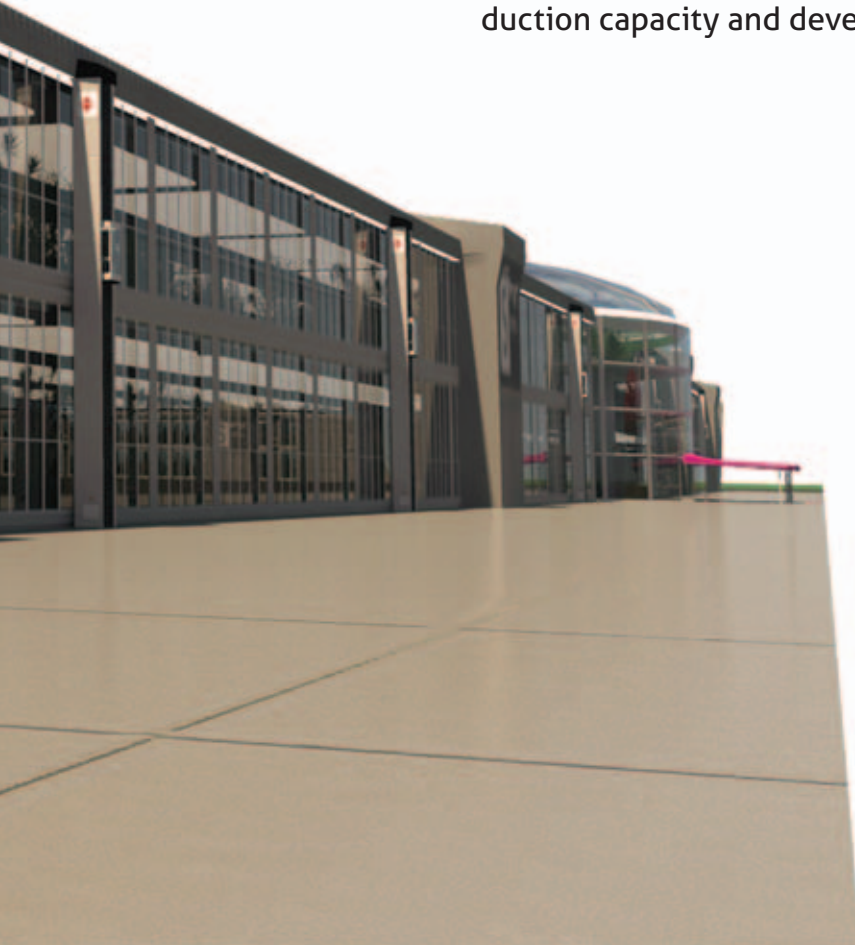

LEVELS -3 & -4



UNDERGROUND-BUNKER LEVELS

These two floors only connected also to the two above would be used as a food storage depot including full water deposits, air and water filtering systems, water pumping station, energy plant based on battery section, solar power form above plants and bio-gas plant.

Alternative emergency power plants are built to produce sufficient energy for one-year+ if required due to complete exterior power shut down.



BUNKER STAFF HOUSING

One to five thousand plus people can remain inside and maintain the project production including government authorities, military staff, engineers, catering, medical staff, security, educational, bio-engineers, chemical engineers, architects, mechanics, builders, etc, to which a new exterior plant could be made operational once the exterior threat can be cancelled or nullified.



EXTERNAL STAFF HOUSING



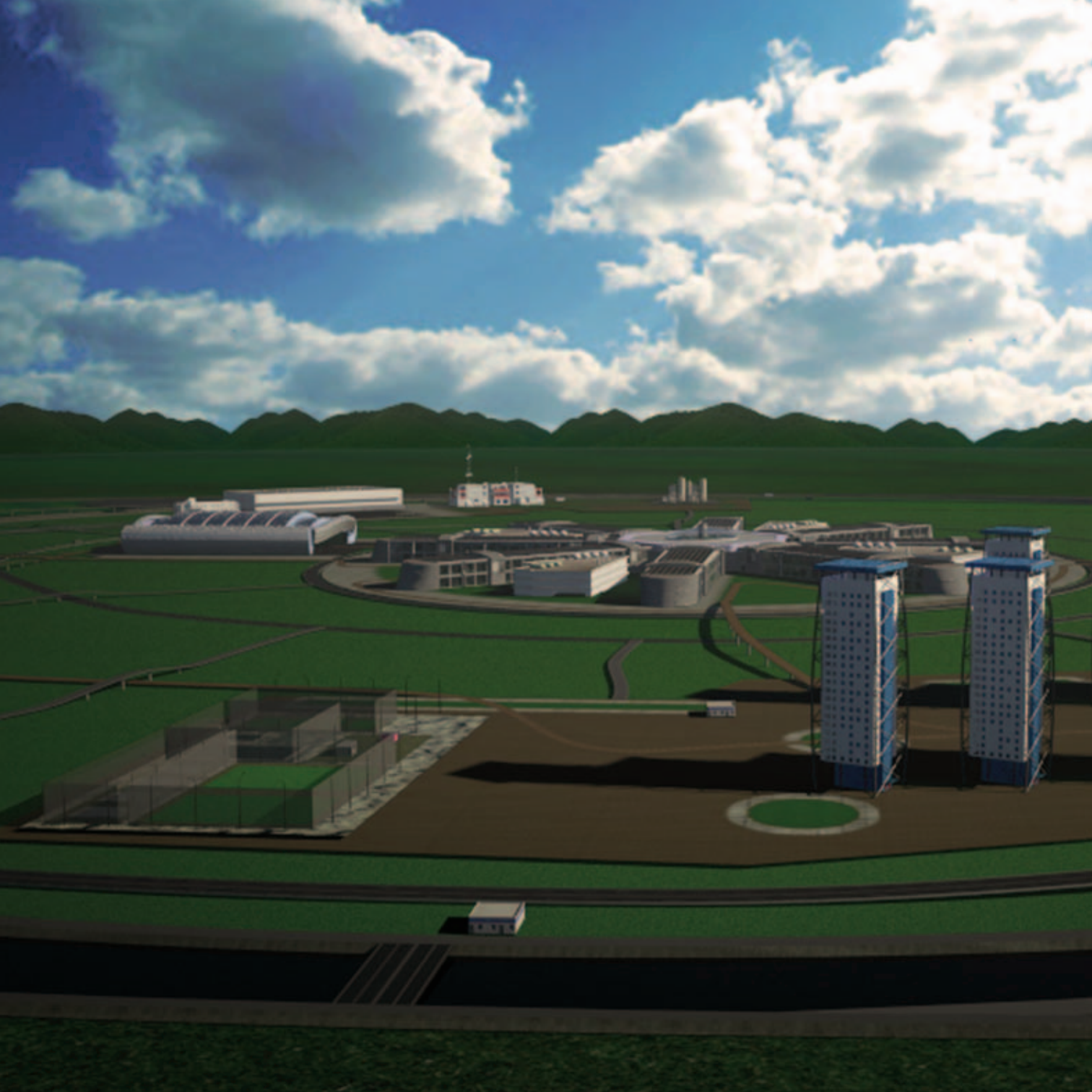



SEEDS/EQUIPMENT STOCK

We have a large stock of all required seeds and seedlings to begin exterior production and the capacity to create our own seedling plants if required and also to maintain internal food reproduction and continuous food production.

Full storage of all equipment and materials to assist soil changes and irrigation systems to adapt to new possible exterior environment.



MOTOR VEHICLES, GENERATORS, POWER PLANTS

Will be stored in two categories:

Category 1

Modern day high yielding machinery with all the technological advances in our normal day activities using bio-fuel, gas, electricity with hardened anti-electromagnetic technology.

Category 2

Pre-electronic operated engine in which in case of an electronic exterior fall out our full machinery capacity will be operational as not having modern day electronic thus not being affected by EMPS or solar, thermal out of space radiation emissions.



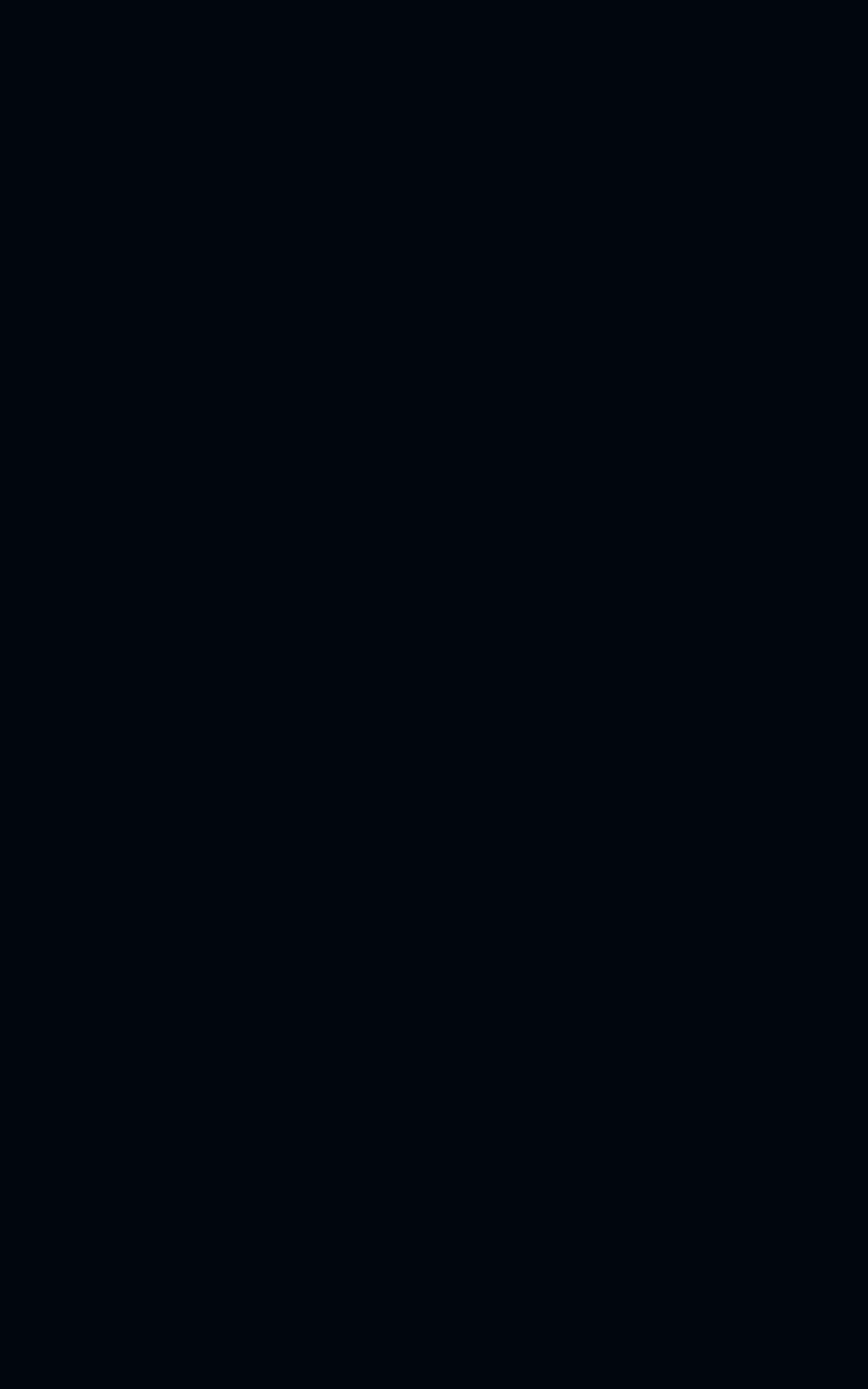



06

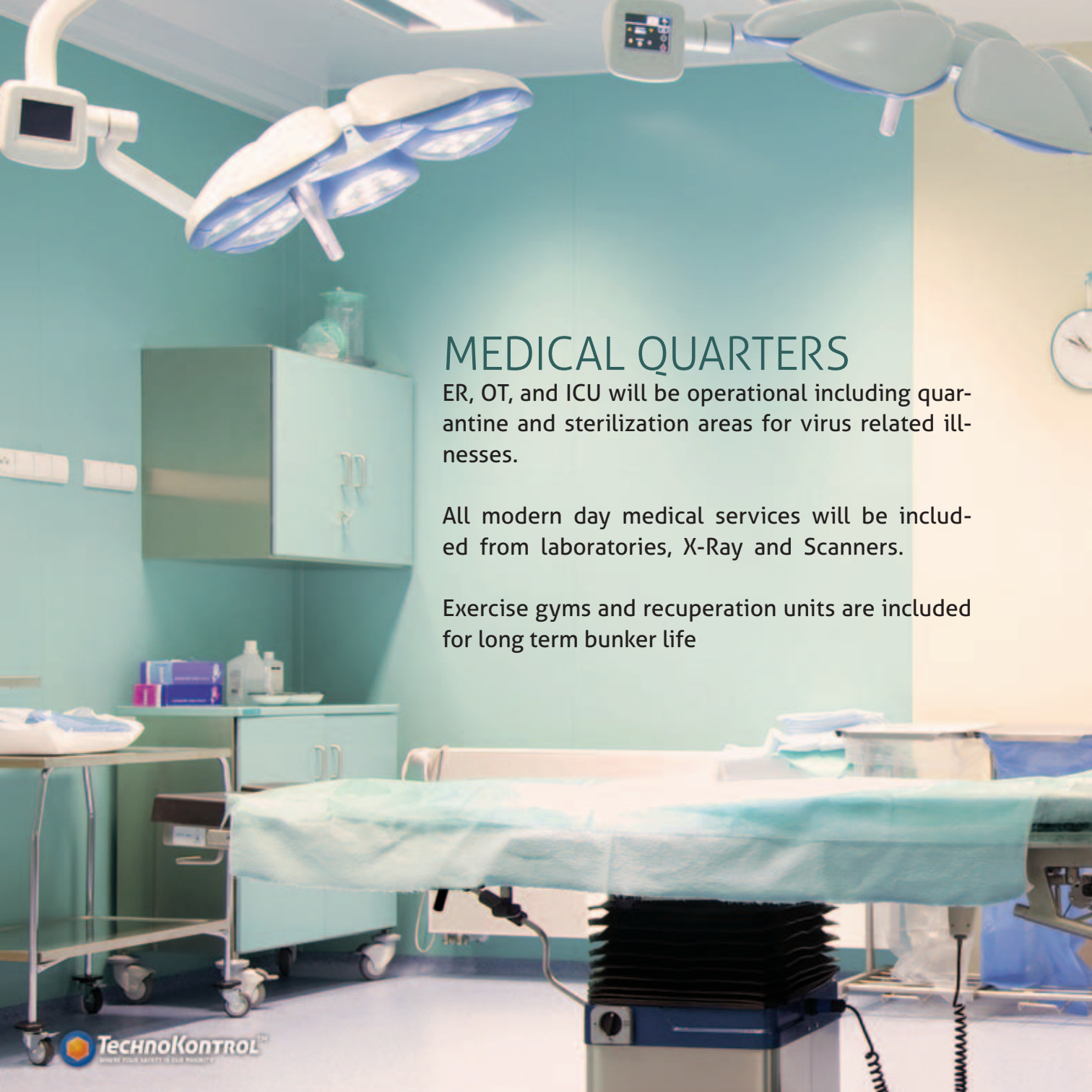

MEDICAL QUARTERS

ER, OT, and ICU will be operational including quarantine and sterilization areas for virus related illnesses.

All modern day medical services will be included from laboratories, X-Ray and Scanners.

Exercise gyms and recuperation units are included for long term bunker life



SECURITY FORCE UNITS

Will be in house to maintain the exterior interior levels under normal management control. In the event of any criminal, terrorist threat or act there will be allocated security cells to prevent any further criminal activities only in the event of "Shut Down" will these emergency regulations be taken into full effect.





EYE SECTION DATA-COMMAND CENTRE



The “Eye Section-Command Centre” is where the operating of the whole plant will be managed. Inside this section, we will have the corporate Head Quarters.

Our full computer and technology systems will be based in this section in which we have full control of all the exterior estate from entrances of deliveries to air cargo exports.

CYBER SECURITY

All the "EYE OF OSIRIS PROJECT" will not have external computer links to the exterior. All information technology will be created and not connected to any external or internal mainframe system.

This will prevent any "hackers or cyber crime", criminal activities to have access to the operational or internal system. External links will exist but with complete independent resources and only on a commercial and information level.

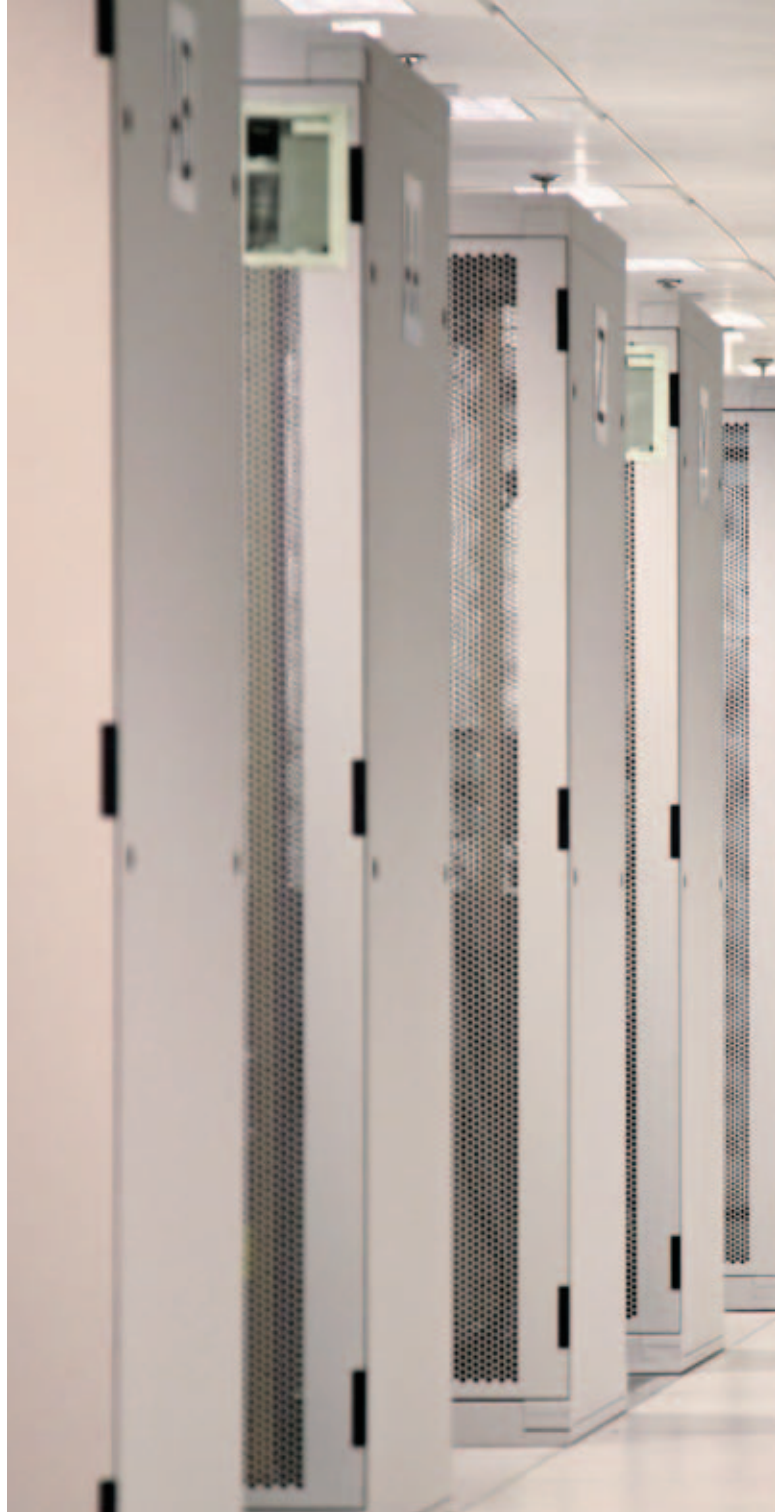



EYE OF OSIRIS COMPLEX

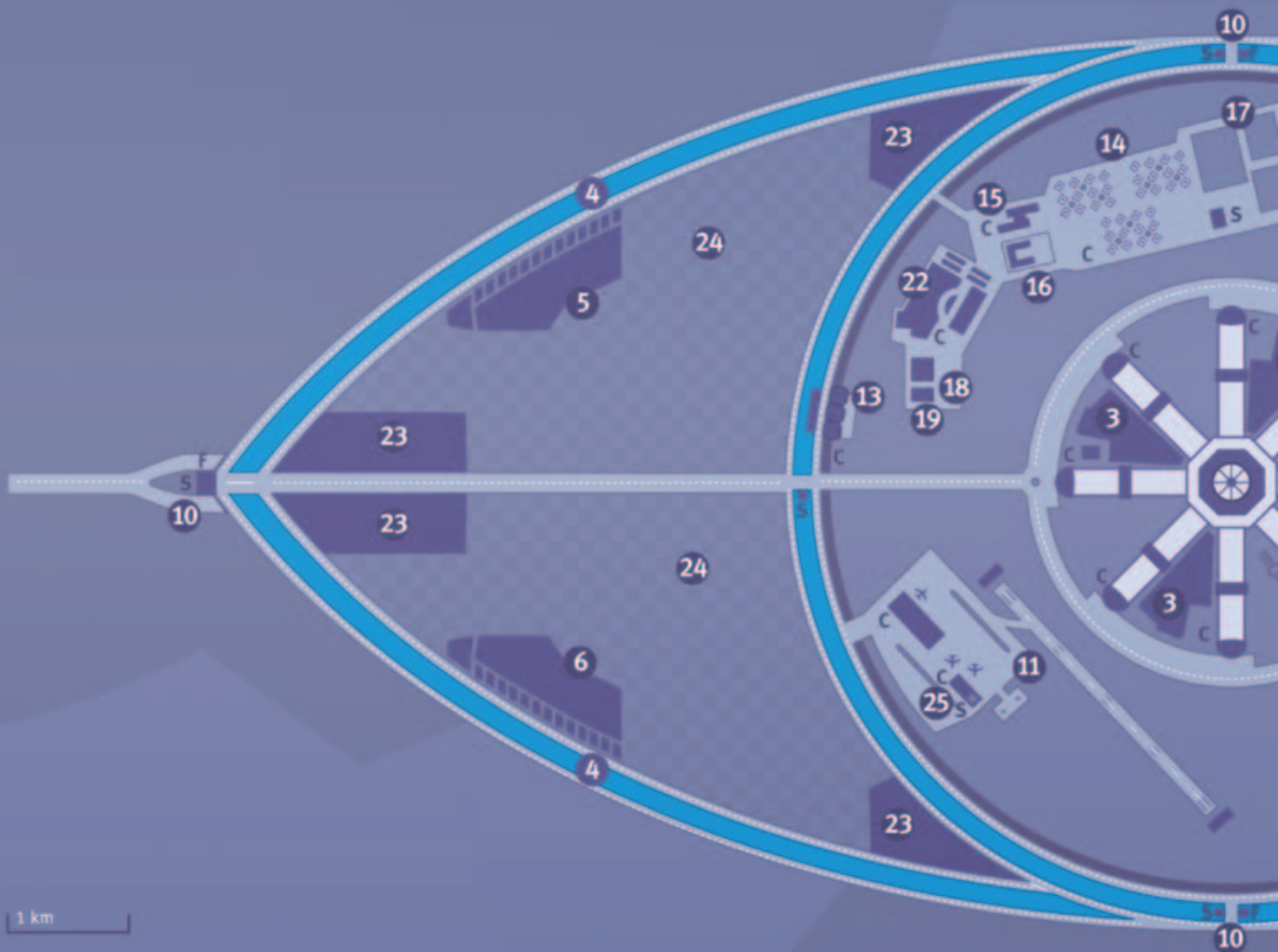

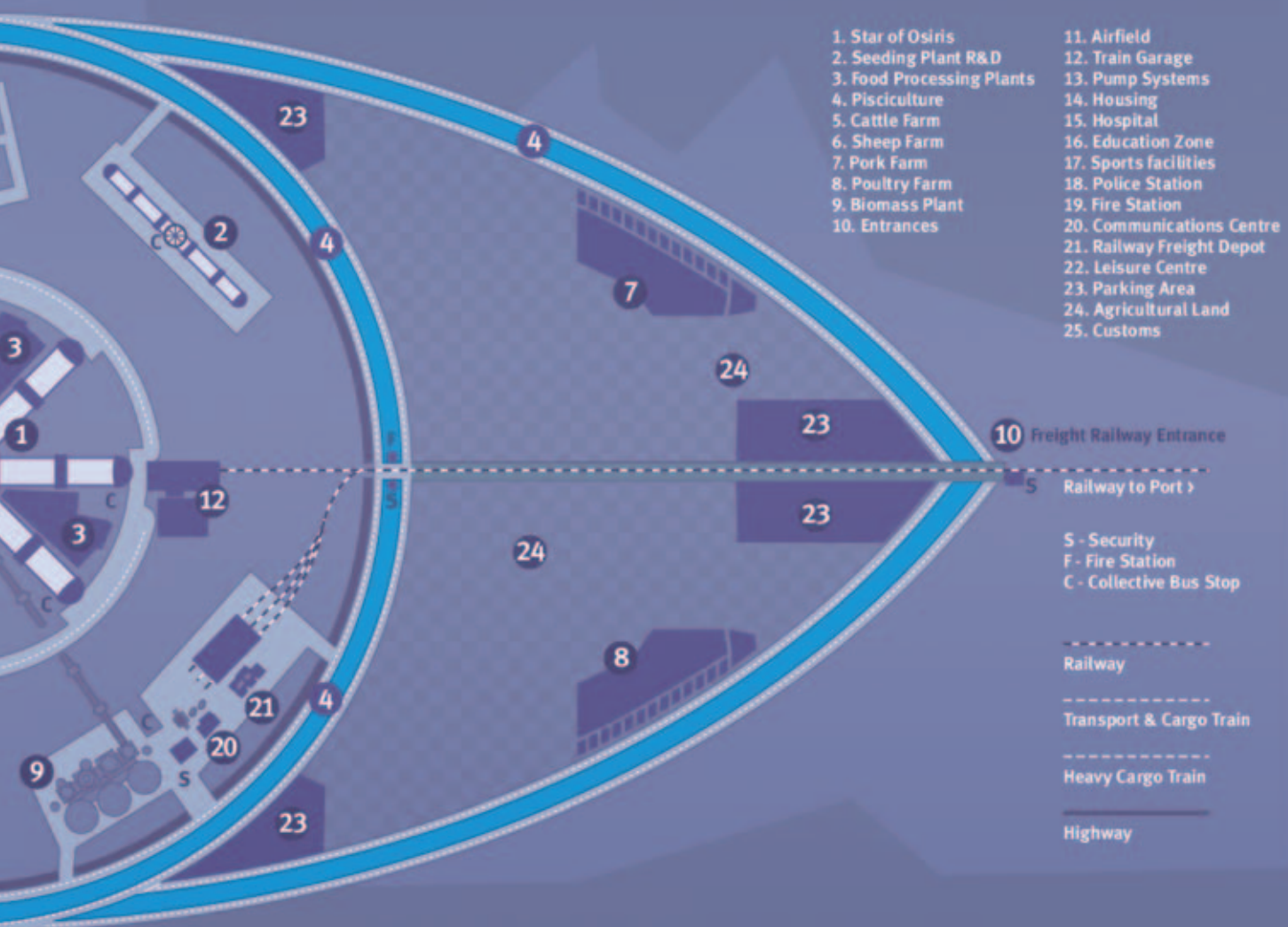

- 1. Star of Osiris
- 2. Seeding Plant R&D
- 3. Food Processing Plants
- 4. Pisciculture
- 5. Cattle Farm
- 6. Sheep Farm
- 7. Pork Farm
- 8. Poultry Farm
- 9. Biomass Plant
- 10. Entrances
- 11. Airfield
- 12. Train Garage
- 13. Pump Systems
- 14. Housing
- 15. Hospital
- 16. Education Zone
- 17. Sports facilities
- 18. Police Station
- 19. Fire Station
- 20. Communications Centre
- 21. Railway Freight Depot
- 22. Leisure Centre
- 23. Parking Area
- 24. Agricultural Land
- 25. Customs

10 Freight Railway Entrance
 5 Railway to Port >

S - Security
 F - Fire Station
 C - Collective Bus Stop

 Railway
 - - - - -
 Transport & Cargo Train
 - - - - -
 Heavy Cargo Train

 Highway

EYE OF OSIRIS LIGHT TRAIN & TRAM ROUTE

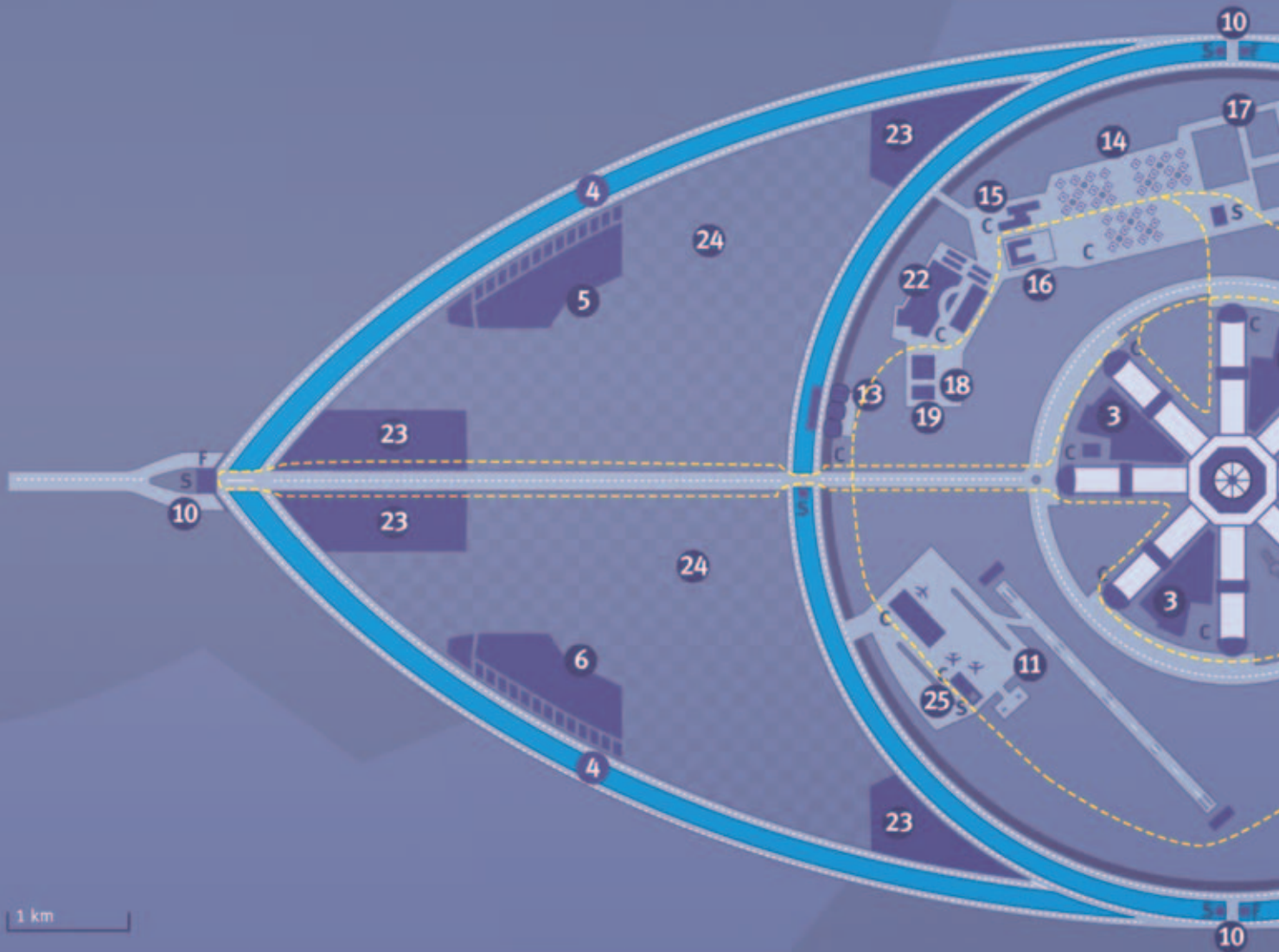

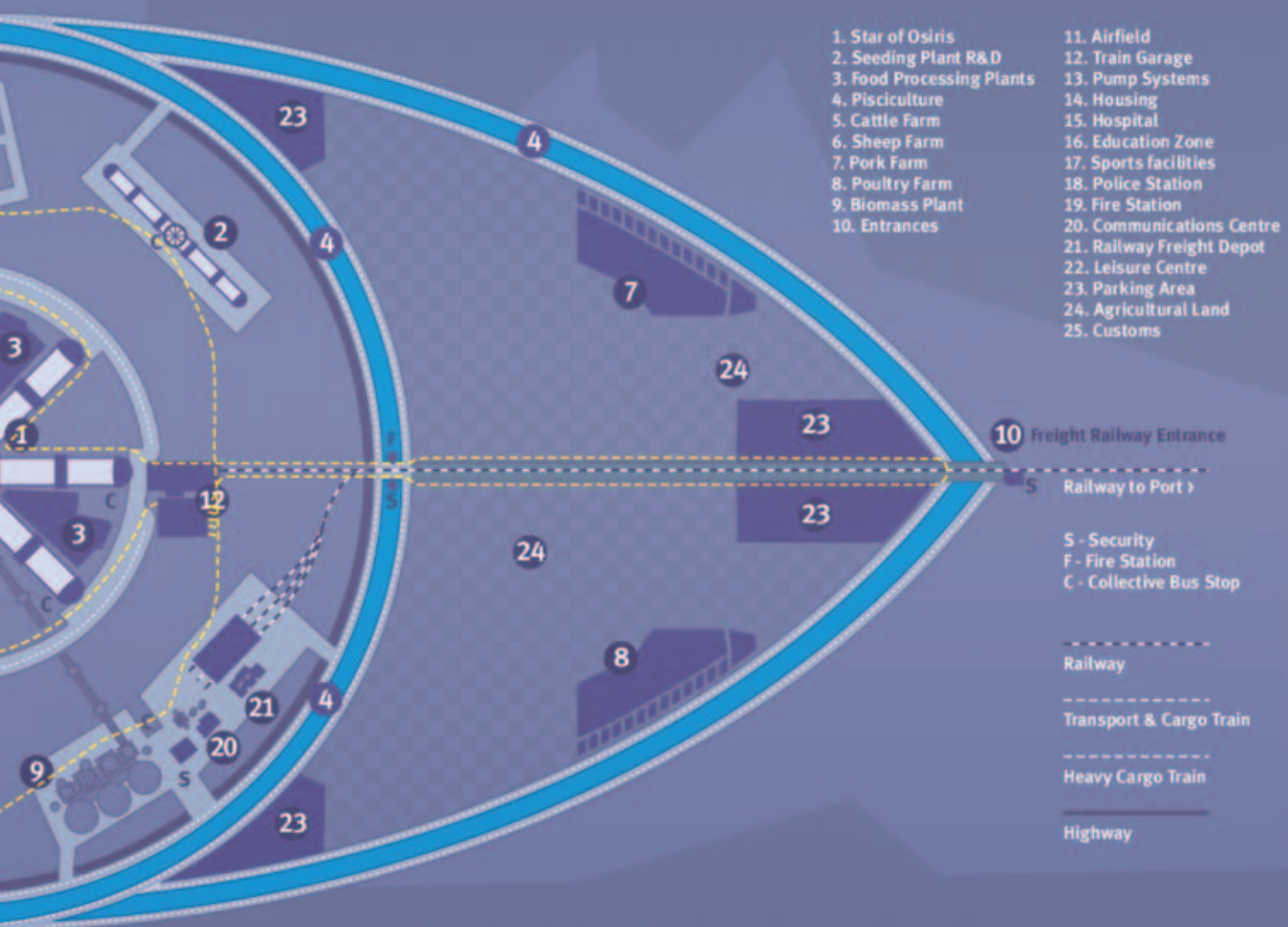

- 1. Star of Osiris
- 2. Seeding Plant R&D
- 3. Food Processing Plants
- 4. Pisciculture
- 5. Cattle Farm
- 6. Sheep Farm
- 7. Pork Farm
- 8. Poultry Farm
- 9. Biomass Plant
- 10. Entrances
- 11. Airfield
- 12. Train Garage
- 13. Pump Systems
- 14. Housing
- 15. Hospital
- 16. Education Zone
- 17. Sports facilities
- 18. Police Station
- 19. Fire Station
- 20. Communications Centre
- 21. Railway Freight Depot
- 22. Leisure Centre
- 23. Parking Area
- 24. Agricultural Land
- 25. Customs

10 Freight Railway Entrance
 5 Railway to Port >

S - Security
 F - Fire Station
 C - Collective Bus Stop

- Railway
- Transport & Cargo Train
- Heavy Cargo Train
- Highway

EYE OF OSIRIS ROADS & HIGHWAYS

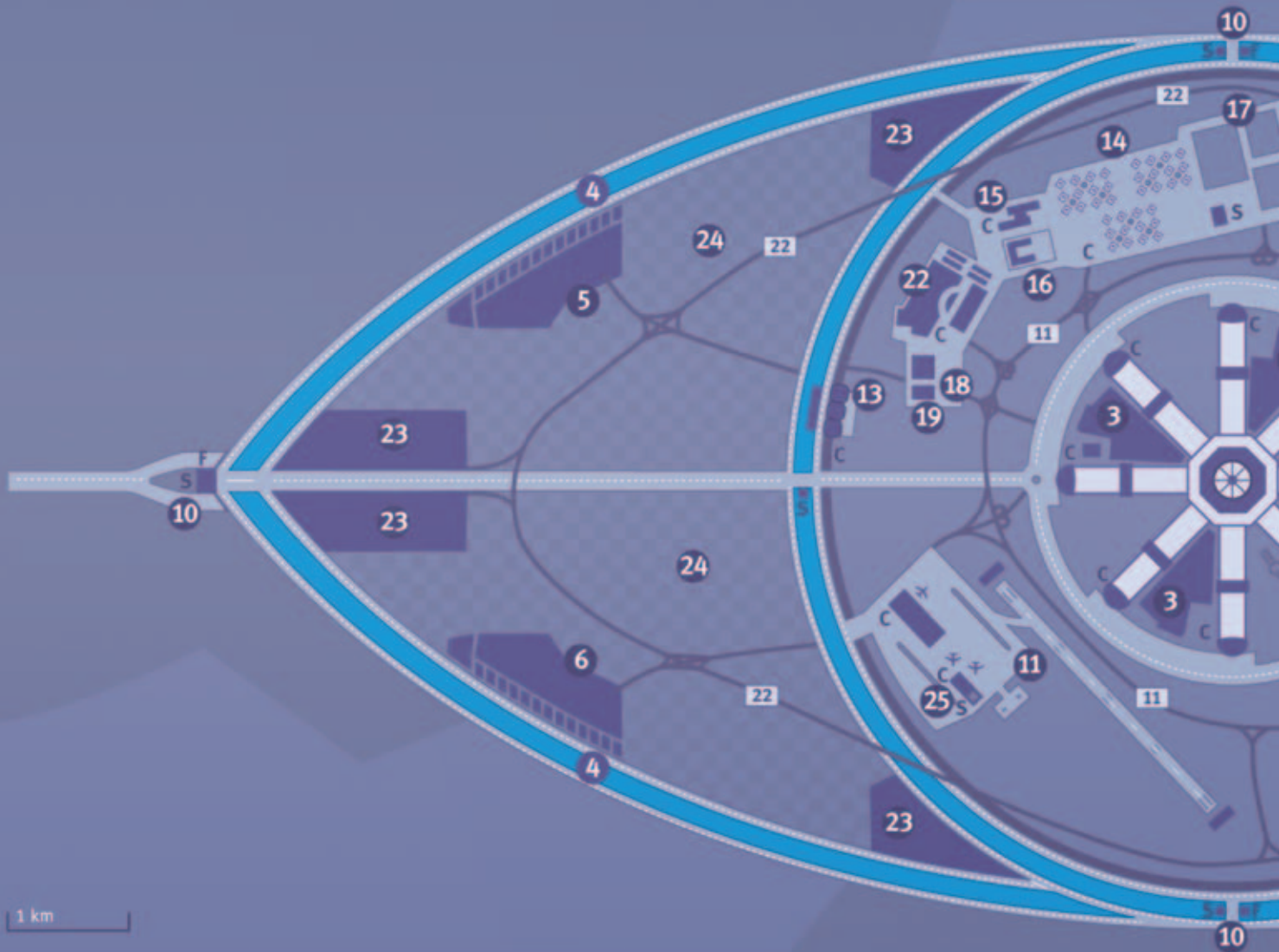

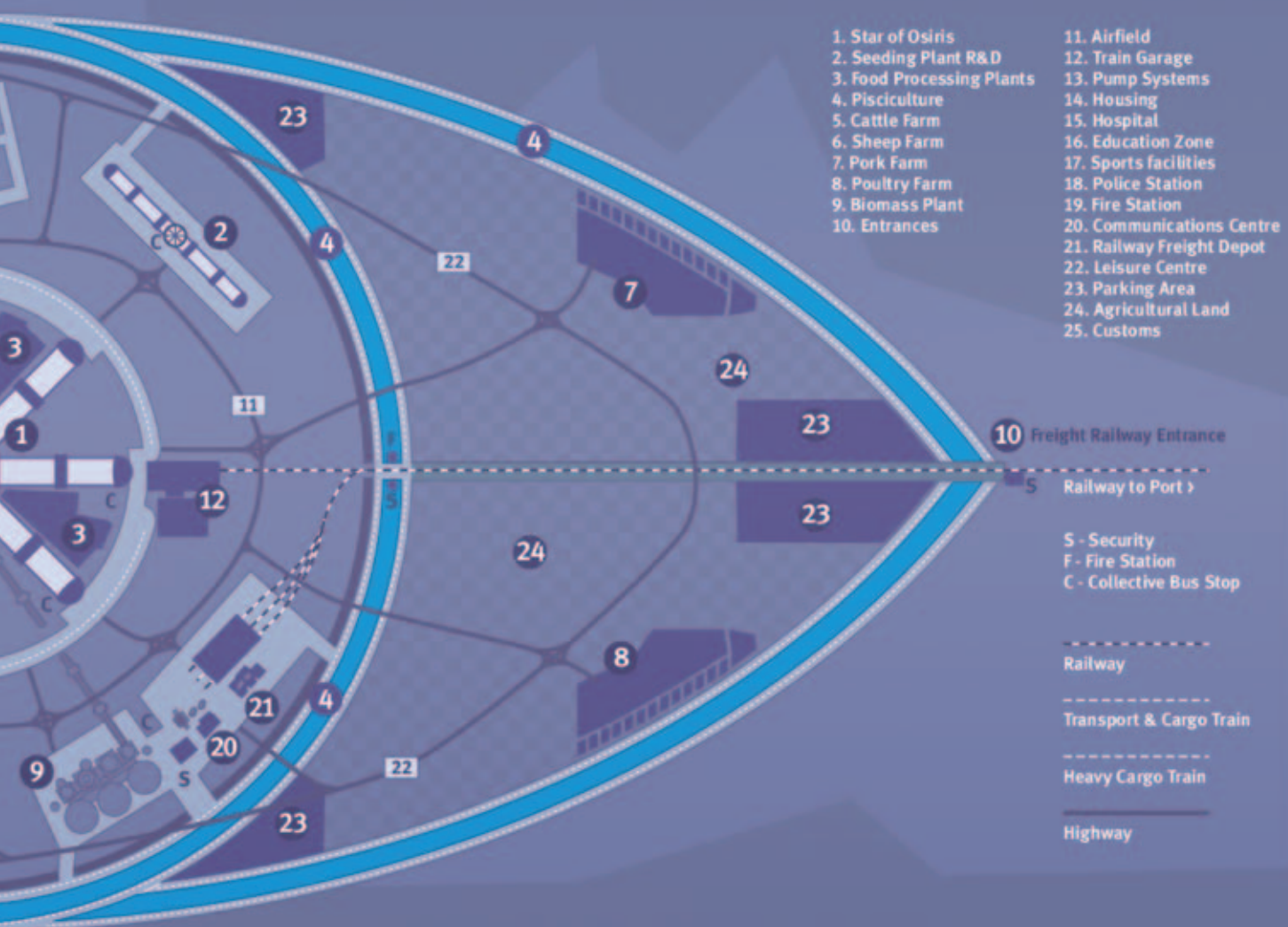

- 1. Star of Osiris
- 2. Seeding Plant R&D
- 3. Food Processing Plants
- 4. Pisciculture
- 5. Cattle Farm
- 6. Sheep Farm
- 7. Pork Farm
- 8. Poultry Farm
- 9. Biomass Plant
- 10. Entrances
- 11. Airfield
- 12. Train Garage
- 13. Pump Systems
- 14. Housing
- 15. Hospital
- 16. Education Zone
- 17. Sports facilities
- 18. Police Station
- 19. Fire Station
- 20. Communications Centre
- 21. Railway Freight Depot
- 22. Leisure Centre
- 23. Parking Area
- 24. Agricultural Land
- 25. Customs

10 Freight Railway Entrance
 5 Railway to Port >

S - Security
 F - Fire Station
 C - Collective Bus Stop

 Railway

 Transport & Cargo Train
 - . - . - .
 Heavy Cargo Train

 Highway

EYE OF OSIRIS FREIGHT RAILROAD

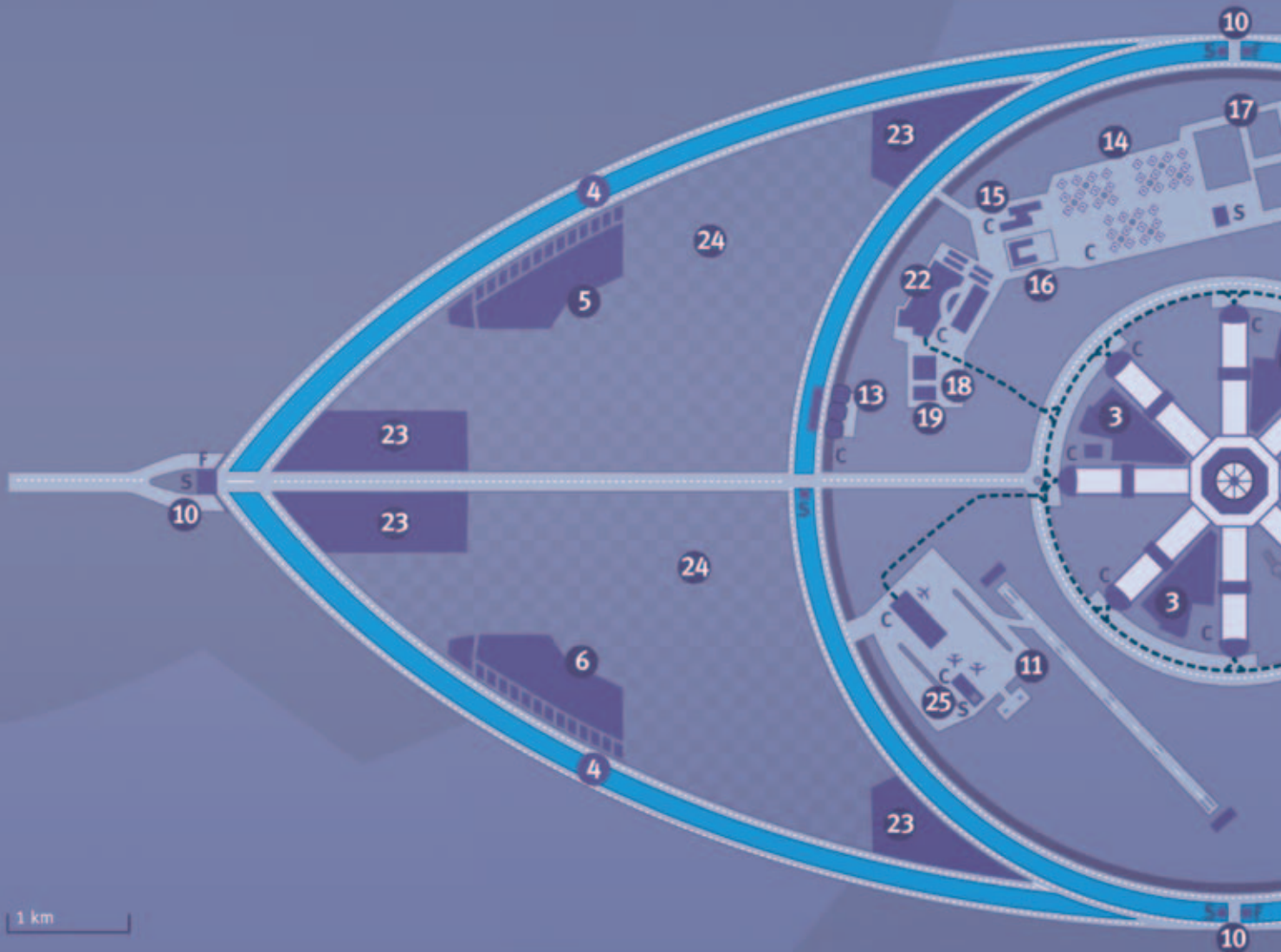

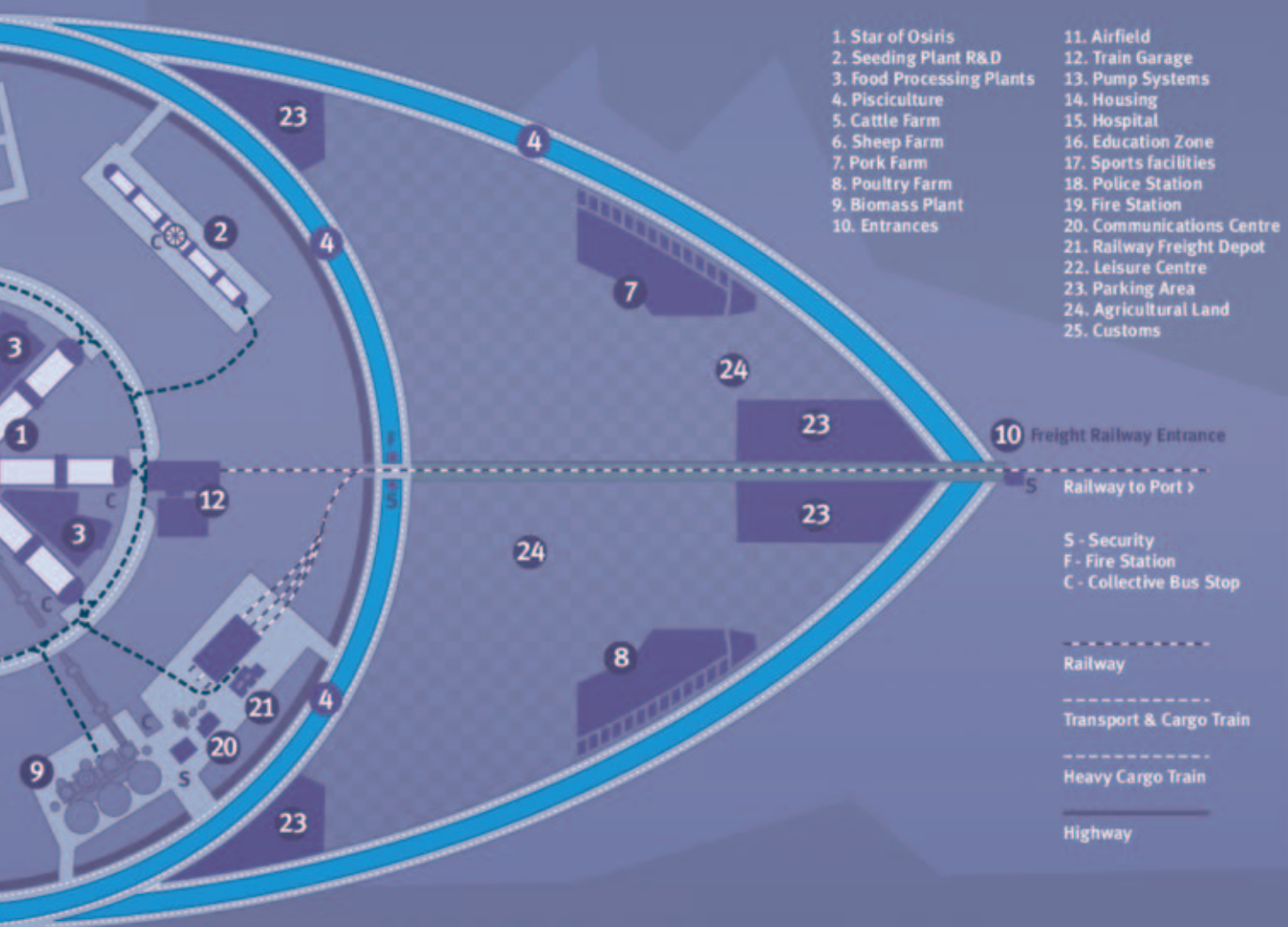

- 1. Star of Osiris
- 2. Seeding Plant R&D
- 3. Food Processing Plants
- 4. Pisciculture
- 5. Cattle Farm
- 6. Sheep Farm
- 7. Pork Farm
- 8. Poultry Farm
- 9. Biomass Plant
- 10. Entrances
- 11. Airfield
- 12. Train Garage
- 13. Pump Systems
- 14. Housing
- 15. Hospital
- 16. Education Zone
- 17. Sports facilities
- 18. Police Station
- 19. Fire Station
- 20. Communications Centre
- 21. Railway Freight Depot
- 22. Leisure Centre
- 23. Parking Area
- 24. Agricultural Land
- 25. Customs

10 Freight Railway Entrance
 5 Railway to Port >

S - Security
 F - Fire Station
 C - Collective Bus Stop

- Railway
- Transport & Cargo Train
- Heavy Cargo Train
- Highway

EYE OF OSIRIS FULL COMMUNICATIONS MAP

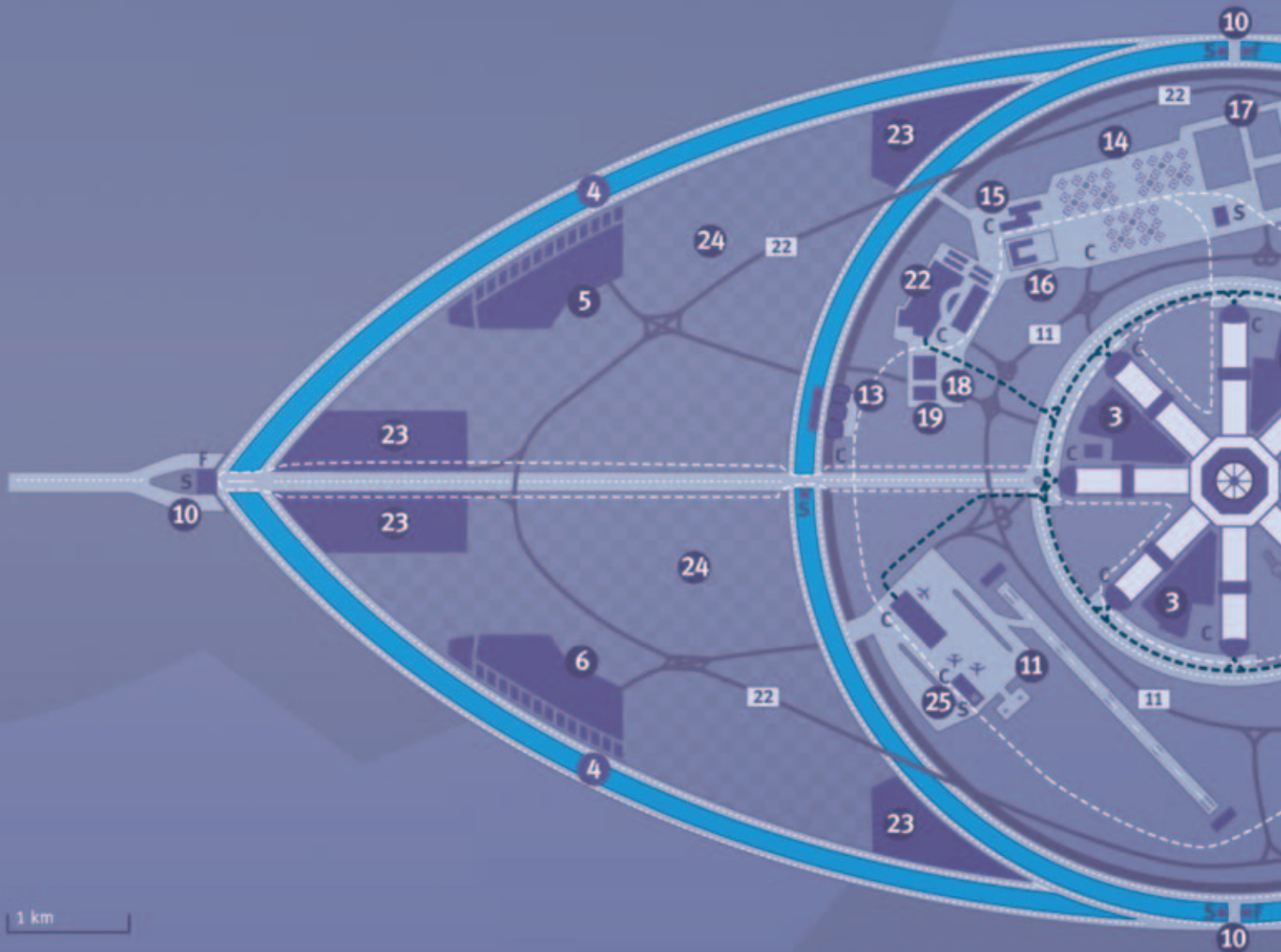

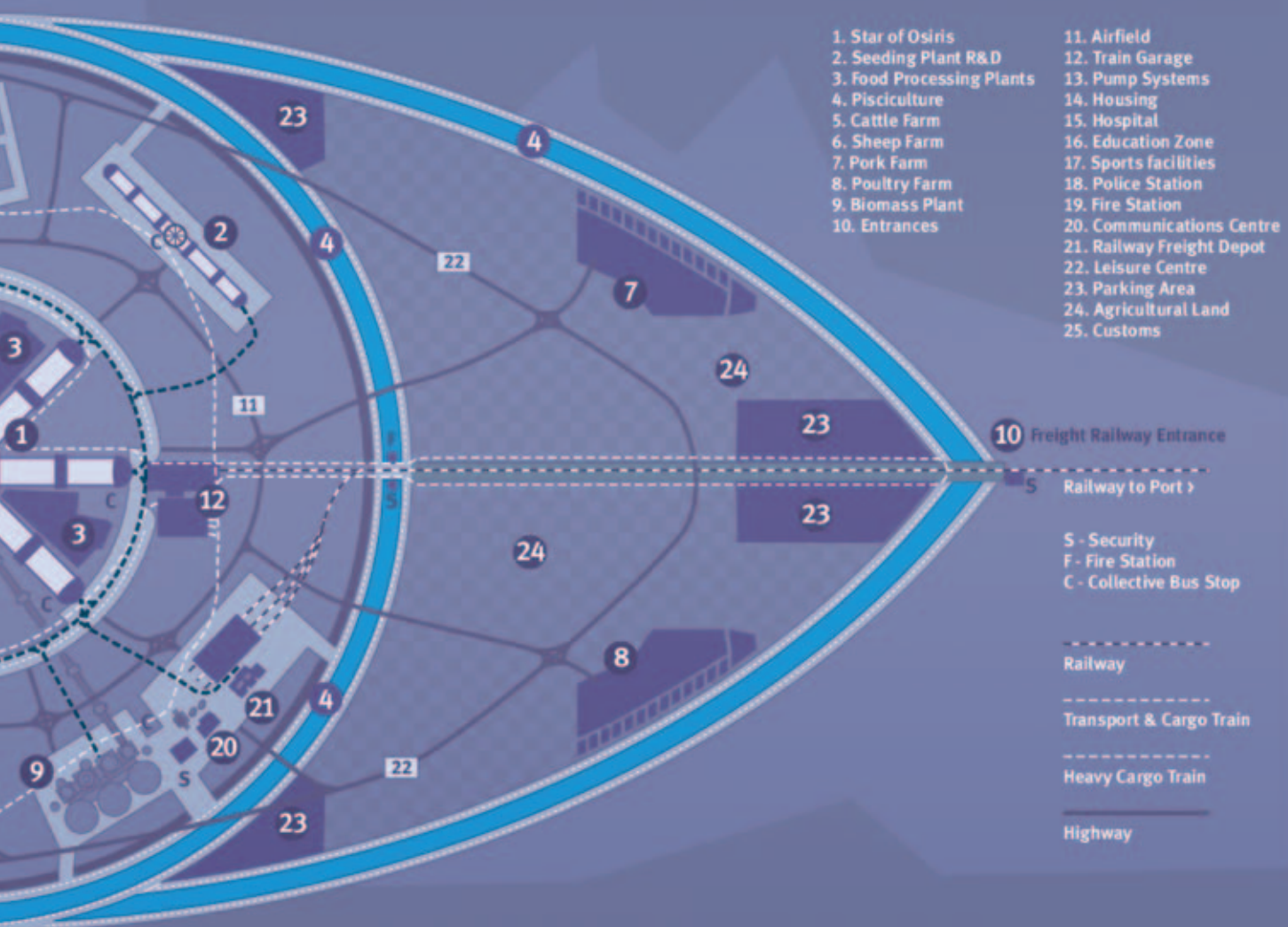

- 1. Star of Osiris
- 2. Seeding Plant R&D
- 3. Food Processing Plants
- 4. Pisciculture
- 5. Cattle Farm
- 6. Sheep Farm
- 7. Pork Farm
- 8. Poultry Farm
- 9. Biomass Plant
- 10. Entrances
- 11. Airfield
- 12. Train Garage
- 13. Pump Systems
- 14. Housing
- 15. Hospital
- 16. Education Zone
- 17. Sports facilities
- 18. Police Station
- 19. Fire Station
- 20. Communications Centre
- 21. Railway Freight Depot
- 22. Leisure Centre
- 23. Parking Area
- 24. Agricultural Land
- 25. Customs

10 Freight Railway Entrance
 5 Railway to Port >

S - Security
 F - Fire Station
 C - Collective Bus Stop

--- Railway
 - - - - - Transport & Cargo Train
 - - - - - Heavy Cargo Train
 _____ Highway







WHERE **RELIABILITY**
QUALITY
SECURITY
AND **PRODUCTIVITY**
BECOME A **REALITY!**



TK-Global Environment™

WHERE EFFICIENCY AND RELIABILITY BECOME A REALITY

TK-EYE OF OSIRIS GLOBAL ENVIRONMENT

Technokontrol Environmental Recycling & Cleaning Services provides onshore and offshore cleaning and decontamination services, supporting a blue-chip client base principally in the oil and gas, petrochemical, heavy industry, manufacturing and pharmaceutical sectors.

In many years of operation we have developed a reputation for pioneering and integrating a wide range of safe, environmentally sound, industrial cleaning techniques involving high pressure water jetting, high airflow vacuum services and chemical decontamination processes.

We complement all our cleaning services with extensive integrated waste management services and on-site waste handling capabilities, as well as utilities infrastructure monitoring and refurbishment services.

MORE INFORMATION



[Click to visit TK Global Environment @ TechnoKontrol](#)





TK Global Technotelecom

WHERE TELECOMMUNICATIONS HAVE NO BOUNDARIES



TK-EYE OF OSIRIS TECHNOTELECOM

A mobile network operator or MNO is a provider of wireless communications services that owns or controls all the elements necessary to sell and deliver services to an end user including radio spectrum allocation, wireless network infrastructure, back haul infrastructure, billing, customer care and provisioning computer systems and marketing, customer care, provisioning and repair organizations.

A key defining characteristic of a mobile network operator is that an MNO must own or control access to a radio spectrum license from a regulatory or government entity. A second key defining characteristic of an MNO is that an MNO must own or control the elements of the network infrastructure that are necessary to provide services to subscribers over the licensed spectrum.

MORE INFORMATION



[Click to visit TK Global Technotelecom @ TechnoKontrol](#)



TK-Global Engineering™

WHERE EFFICIENCY AND RELIABILITY BECOME A REALITY

TK-EYE OF OSIRIS GLOBAL ENGINEERING

In order to ensure that our clients receive the best service possible, through both our product range and our manufacturing facilities we have managed to entice and train one of the most qualified engineering teams available throughout the world today and with their help we are able to complete both our individual and industrial orders accordingly.

We also understand that stress, torque, fire, heat, material, tension, flexibility, nano-technology, textile and construction testing are all critical parts of Technokontrols engineering process and we therefore have provided our engineers with such facilities as a fully integrated 3D computer aided manufacturing (CAD /CAM) system along with many more testing technology aids (i.e. fire, heat, blast and metal stress testing technology) aids (i.e. fire, head, blast and metal stress testing technology) so as to ensure that our clients receive the best service available within the market today.

MORE INFORMATION



[Click to visit TK Global Engineering @ TechnoKontrol](#)





TK-Global Electronics™

WHERE EFFICIENCY AND RELIABILITY BECOME A REALITY



TK-EYE OF OSIRIS GLOBAL ELECTRONICS

Technokontrol Electronics R&D dedicates a great part of its engineering research & development in mainly highly sophisticated Engineering Programs, especially, for the use of its unique developed technologies for our main technological products as in our "Eagle Eye Aviation Program", "King Shark Naval Program", "Fiber Optics" , "Detection & Sensors Technologies", "Anti-EMPS Technologies", etc

Technokontrol R&D continues in our reporting on research and development in all electronic engineering, optical science, defense engineering and electromagnetic technologies and the practical applications of known optical science, engineering, and technology.

MORE INFORMATION



[Click to visit TK Global Electronics @ TechnoKontrol](#)



TK-EYE OF OSIRIS EMERGENCY COMMMAND-CALL CENTRE AND VISUAL TECHNOLOGIES

24/7/365 DAYS OF THE YEAR

TechnoKontrol has a well managed and professional Client Emergency Call Center can receive calls from navy ships, ground troops, petrol-chemical corporations, government technical departments which can deal or assist with all types or technical queries or issues controlled from our call center. All of our staff have at least three (3) years experience and are all ITIL trained and certified.

TechnoKontrol Call Center has an online 24 hours, 365 days conference call center via internet or telephone which is used to assist and to control any of Technokontrol's technologies or products in any global location.

Once the call center receives any call regarding any kind or type of issue regarding our products, servicing, repairing or maintenance we will try to assist online with all data required to assist in-situ such enquiry or assistance.

MORE INFORMATION

 [Click to visit Emergency Command Call Centre @ TechnoKontrol](#)



TK-EYE OF OSIRIS MILITARY-LAW ENFORCEMENT-POLICE SPECIALIST PROTECTIVE BUILDINGS AND LIVING QUARTERS DESIGNS

TK-Housing Projects has the answer to all types of accommodation needs through an innovative system of modular prefabricated houses that represents the immediate future in the world of construction.

Thanks to our system we can assure our clients incredibly rapid terms on delivery and huge savings on costs and transport and an amazing timescale from order to a completed house.

Another advantage of our system is that we can build these homes, schools, hospitals with or without basic infrastructures as water, electricity, sewage, roads, etc.

Our buildings are custom made for each client or government and we only wish to produce a long lasting product with a long term quality guarantee which is paramount for TechnoKontrol's reputation as a global leader in the safety-security sector.

MORE INFORMATION



[Click to visit Law Enforcement-Police Buildings @ TechnoKontrol](#)



TK-EYE OF OSIRIS ELITE BLACK NIGHT VIPER SECURITY SERVICES

Technokontrol the sister corporation of "Elite Black Night Viper EBNVSS-Security Services ©" is a leading private security and risk management company with offices in Madrid, Barcelona, Colombia, Ecuador, Bolivia, Libya, etc, and an additional presence across the Middle East, Northern Africa and South-Central America.

Our security and advisory divisions provide a comprehensive service covering all areas of the globe, combining the proven track record and expertise that enable our clients - multi-nationals, governments, international agencies and many others - to minimise risk and maximise opportunity.

With a network of offices, staff and contacts world-wide we can provide detailed advice and support carefully tailored to the specific requirements of our clients as they explore the possibilities of extending their operations; as well as vital, dependable security and commercial insight once they are on the ground.

MORE INFORMATION

 [Click to visit EBNV Security Services @ TechnoKontrol](#)



BLACK NIGHT VIPER

TK-MILITARY TECHNOLOGIES

BATTLEFIELD SHADOWHUNTER



TK-EYE OF OSIRIS-SEARCH & RESCUE COMBAT SEARCH & RESCUE

Search and rescue (SAR or S&R) is the search for and provision of aid to people who are in distress or imminent danger.

The general field of search and rescue includes many specialty sub-fields, typically determined by the type of terrain the search is conducted over.

These include mountain rescue; ground search and rescue, including the use of search and rescue dogs; urban search and rescue in cities; combat search and rescue on the battlefield and air-sea rescue over water.

Combat search and rescue (CSAR) are search and rescue operations that are carried out during war that are within or near combat zones.

A CSAR mission may be carried out by a task force of helicopters, ground-attack aircraft, aerial refueling tankers and an airborne command post.

MORE INFORMATION



Click to visit Search & Rescue/Combat SAR @ TechnoKontrol



CERTIFICATES



**Architects
Engineers
Building
Officials
Section**

JAA



CE



SOUTHWEST



National Fire Protection Association
The authority on fire, electrical and building safety



LEGAL NOTICE

Copyrights TechnoKontrol Cat Global S.L. All Rights Reserved. The text, images, graphics, sound files, animation files, video files and their arrangement on TechnoKontrol Cat Global S.L. Internet sites are all subject to Copyright and other intellectual property protection. These objects may not be copied for commercial use or distribution, nor may these objects be modified or reposted to other sites. Some Technokontrol Internet sites also contain material that is subject to the copyright rights of their providers. All modifications of the web or publicity can be done as the corporation requires. All web and publicity information is not contractual but only information.

Product variations. Some of the product information, illustrations and images contained on this Internet site or all types of publicity may have been prepared for generic use on Technokontrol Internet sites maintained in different countries around the world. Consequently, some of the information and/or accessories which are not available in some countries or which, in order to satisfy local market demand or regulatory controls in such countries, may only be available in different specifications or configurations.

If you are interested in any product, alloy, services, options or accessory shown on the Internet site or publicity and are unsure of its availability or specification in your locality, you should contact TechnoKontrol Cat Global S.L. and/or a local authorized dealer for the relevant product, for information of current details in your locality.

DISCLAIMER

We do not make representation that information and materials on this website and corporate publicity are appropriate for use in all jurisdictions available on the web, or that transactions, securities, products, instruments or services offered on this website or publicity are available or indeed appropriate for sale or use in all jurisdictions, or by all investors or other potential clients. Those who access this website or publicity do so on their own initiative, and are therefore responsible for compliance with applicable local laws and regulations. By accessing each site, the entrant has agreed that he/she has reviewed the website or publicity in its entirety including any legal or regulatory terms.

AVISO LEGAL

PROPIEDAD INDUSTRIAL E INTELECTUAL

Estos textos e imágenes, así como todo tipo de publicidad en cualquier formato es propiedad de TechnoKontrol Cat Global SL. Los derechos de Propiedad Intelectual y derechos de explotación y reproducción de esta Web y publicidad, de sus páginas, pantallas, la información que contienen, su apariencia y diseño, así como los vínculos ("hiperlinks") que se establezcan desde ella a otras páginas web de cualquier sociedad perteneciente al Grupo, son propiedad exclusiva de éste salvo que se especifique otra cosa. Todas las denominaciones, diseños y/o logotipos que componen esta página son marcas debidamente registradas. Cualquier uso indebido de las mismas por persona diferente de su legítimo titular podrá ser perseguido de conformidad con la legislación vigente. Los derechos de propiedad intelectual y marcas de terceros están destacados convenientemente y deben ser respetados por todo aquel que acceda a la Web y los folletos informativos. Solo para uso personal y privado se permite descargar los contenidos, copiar o imprimir cualquier página de esta Web. Queda prohibido reproducir, transmitir, modificar o suprimir la información, contenido o advertencias de esta Web sin la previa autorización escrita de TechnoKontrol Cat Global S.L. Toda la información expuesta en la página web o en cualquier tipo de formato publicitario es únicamente informativo y no constituye ninguna obligación contractual.

DROITS D'AUTEUR

Copyright TechnoKontrol Cat Global S.L.. Tous droits réservés. Tous les textes, images, graphiques, sons, vidéo et animations ainsi que leur arrangement ou disposition sont protégés au titre du droit d'auteur et aux autres lois relatives à la protection de la propriété intellectuelle. Ils ne peuvent être ni modifiés, ni copiés à des fins commerciales ou à des fins de reproduction, ni utilisés sur d'autres sites web.

Marques commerciales. En l'absence d'indication contraire, toutes les marques mentionnées sur les pages internet de Technokontrol sont des marques déposées par TechnoKontrol Cat Global S.L. et protégées sur un plan légal. Cela concerne en particulier les noms de produits ou services ainsi que tous les logos et emblèmes du groupe TechnoKontrol Cat Global .S.L.





TECHNOKONTROL

Ms. L. Cañada

C.E.O.

lcanada@technokontrol.com

Tel +(34) 698 893 269

SALES

Mr. David Doyle

info@technokontrol.com

www.technokontrol.com

Ms. Sonia Martín

sales@technokontrol.com

Tel 902 002 005

Fax 902 002 006